

# DAS NOAH+ STIEGE 1 / TOP 1

Adresse: 1130 Wien - Lainzerstraße 172/1/1  
Zimmer: 2  
Geschoß: EG  
Fläche: 60,93 m<sup>2</sup>  
Freifläche(n): 64 m<sup>2</sup> Garten | 14 m<sup>2</sup> Terrasse  
Ausrichtung: Westen  
Fertigstellung: Geplant Frühling 2024

Kaufpreis brutto: € 458.300  
Monatliche Kosten: € 227,96

Nutzungsart: Wohnen (Eigentum)  
HWB: 29,40 kWh/m<sup>2</sup>a  
f<sub>GEE</sub> 0,76





## PROJEKTBIKD

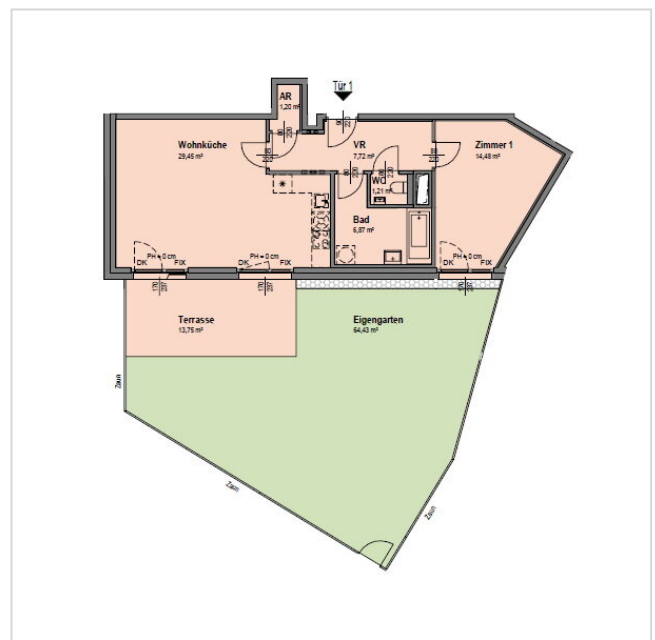

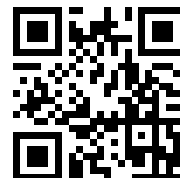
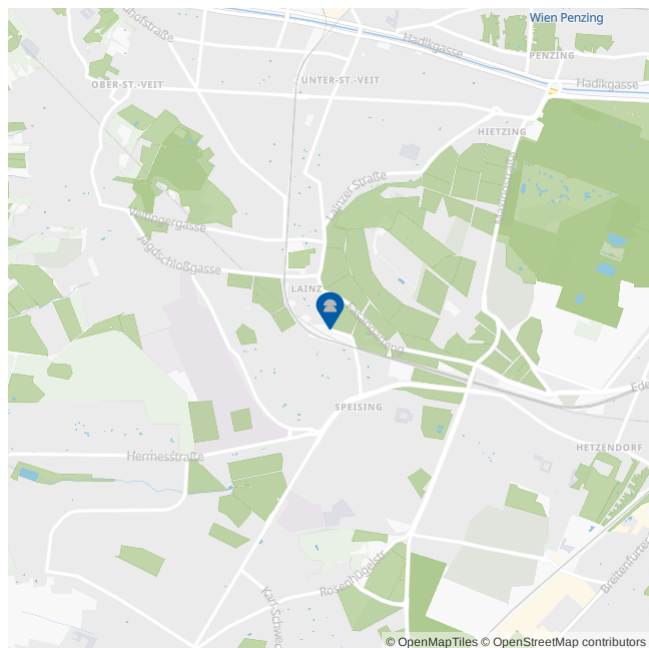
## GRUNDRISS



**LAGE & UMGEBUNG** | 1130 Wien - Lainzerstraße 172/1/1

-  Buslinien 56A,56B,N60 < 100 m  
Straßenbahn 60,62 < 100 m
-  Supermärkte < 500 m
-  Krankenhaus Hietzing < 2 km
-  Öffentl. Parks < 1 km